

Notes

1. This drawing has been prepared in accordance with the scope of RPS's appointment with its client and is subject to the terms and conditions of that appointment. RPS accepts no liability for any use of this document other than by its client and only for the purposes for which it was prepared and provided.
2. If received electronically it is the recipient's responsibility to print to correct scale. Only written dimensions should be used.
3. This drawing should be read in conjunction with all other relevant drawings and specifications.

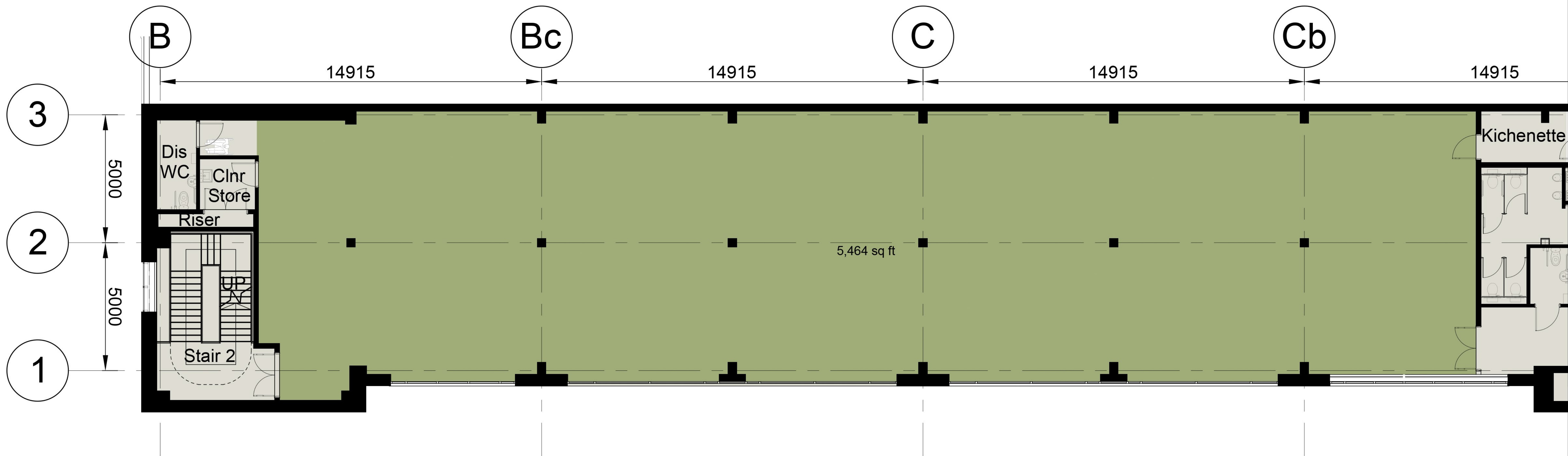

First Floor Potential Office Layout
Total Available Space - 5,464 sq ft

Rev	Description	By	Ckd	Date
A	Labels updated	DEC	MJH	11/06/18



Sherwood House, Sherwood Avenue,
Newark, Nottinghamshire, NG24 1QQ
T: 01636 605 700 E: rpsnewark@rpsgroup.com

Client



Project DP World London Gateway
Logistics Centre

Title Phase 2 Offices First Floor
Marketing Image

Status	Scale	Date Created
Preliminary	1:75 @A1	07/06/18
Project Leader	Drawn By	Checked by
KRP	DEC	MJH

Document Number	Revision	Subsidiary
NK018210-SK023	A	S0

1m SCALE 1:75